



# Farmers Electric Cooperative

A Touchstone Energy Cooperative

301 N. Hillcrest  
Sulphur Springs, TX 75482

2000 I-30 E  
Greenville, TX 75402

108 W. Marble  
Wylie, TX 75098

Thursday, December 26, 2019

Office of Hopkins County Judge  
PO Box 288  
Sulphur Springs TX 75483

Farmers Electric Cooperative Member: JONATHAN CAMERON  
Service Order Number: 1912002765

Greetings:

Farmers Electric Cooperative, Inc. is requesting permission to construct electrical power distribution facilities which will cross County Road 3310 which is located, 200 ft southwest of CR 3378 in Hopkins County, Texas.

Site location map and construction sketches are enclosed. The construction sketch details the proposed work. The underground service will be TRENCHED across CR 3310 by request of the member, rather than typically being bored under the road. Farmers Electric Cooperative will not be held liable for any repair work that may need to be done to the road.

If you have any questions, please contact me at any time.

Sincerely,

*Matthew Walker*

Project Coordinator  
mwalker@farmerselectric.coop  
Phone 903-441-1368

Submitted by Brandon Darrow  
bdarrow@farmerselectric.coop  
Field Engineering Coordinator

Enclosures

County Approval Section:

Approved:

Denied:

Authorized Signature: Wade Bentley

Date: 12-27-19

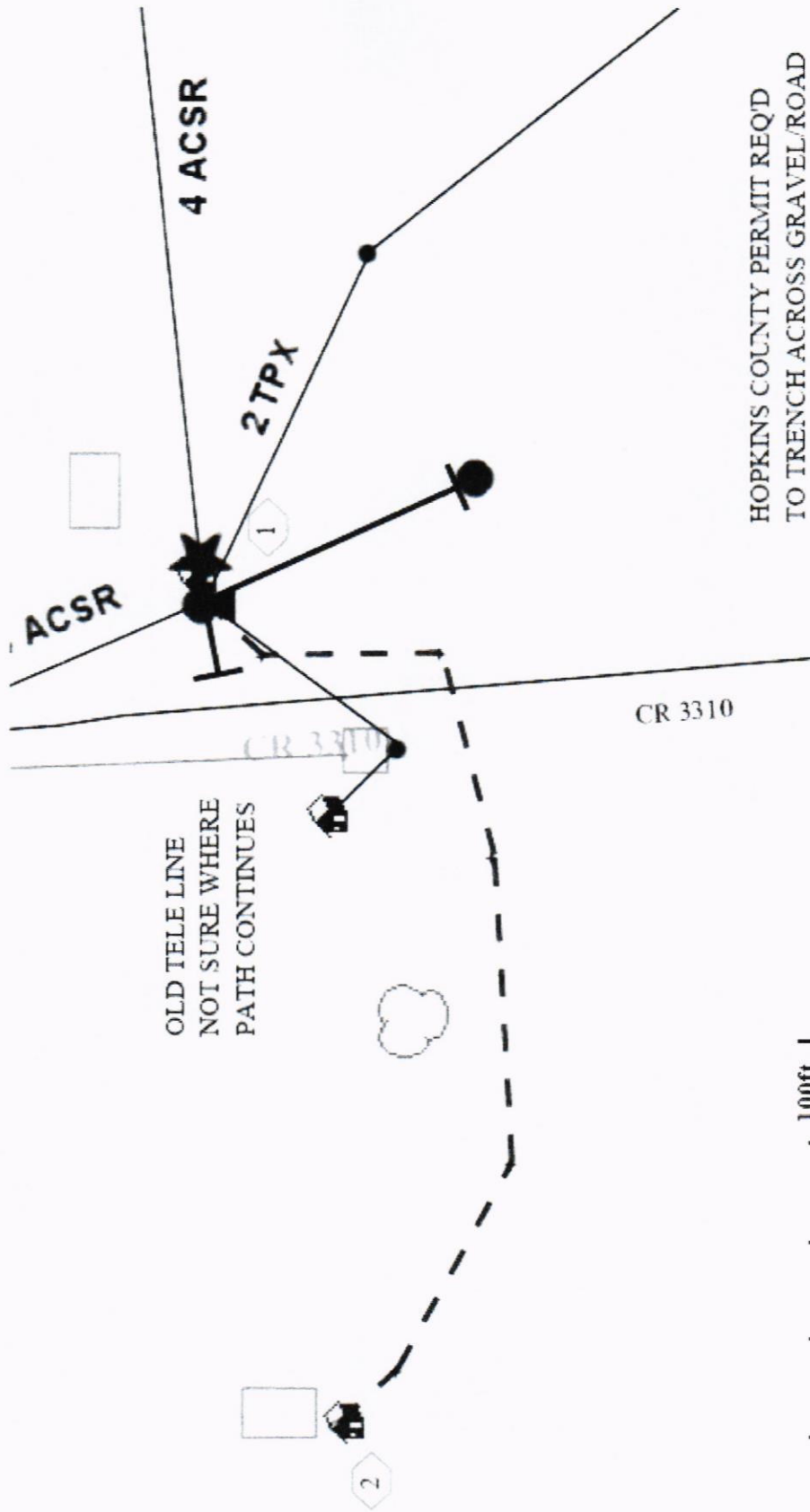

Jonathan Cameron  
Service Order#  
1912002765  
Trench Across Cross  
CR 3310.



County Road 3310

2324

County Road 3310

County Road 3378

